

BIDDING AND CONTRACT DOCUMENTS
Section 00 21 15 – Addendum No. 2

DATE: May 22, 2024

Hurst-Rosche, Inc.
200 N. Market Street
Marion, Illinois 62959
Hurst-Rosche Project #395-3272

TO: PROSPECTIVE BIDDERS

SUBJECT: ADDENDUM NO. 2 TO THE BIDDING DOCUMENTS FOR

Athletic Training Facility
Wabash Valley College
Illinois Eastern Community Colleges
2200 College Drive
Mt. Carmel, Wabash County, Illinois 62863
HR: 395-3272

This addendum forms a part of the bidding and contract documents and modifies the bidding documents dated April 23, 2024. Acknowledge receipt of this addendum in space provided on Bid Form. FAILURE TO DO SO MAY SUBJECT BIDDER TO DISQUALIFICATION.

.....

This addendum is being issued in lieu of meeting minutes for the pre-bid meeting held on May 15, 2024. If there was anything discussed in the meeting, or needs further clarification, that was omitted in these minutes please inform the A/E promptly.

SPECIFICATIONS

11. Attach Request for Interpretation Pre-Bid Question and Comment Form to the end of 00 21 14.
12. Specification Section 00 21 14: Update last day to submit Request for Information to 05/24 at 4:30 pm

DRAWINGS

13. Revised C-100 to include control points from survey, as well as relevant information.
14. Drawing 2 sheet A-303, the plywood should be called out as 1/2" rather than 3/8".

CLARIFICATIONS

15. RFI's will be accepted via email sent to apape@hurst-rosche.com. RFI's should clearly indicate what information is being requested and relevant sections of the project documents in question. RFIPBQC Form attached for contractors convenience.
16. Section 00 21 14 – Instructions to Bidder.
 1. Update in Section 1.4 subparagraph K. Update number in parentheses to (5%).
17. Regarding the scope of work involving the relocation of the existing utility pole and associated services as described on drawings C-100, C-101.
 2. The utility pole and associated feeder line is a private line owned by an oil company. .

3. Permission has been given to Wabash Valley College by the oil company to move the utility pole.
18. On C- 100 removal of the existing scoreboard is part of the contract. On C-101 the running of a new electrical service to from building for a new scoreboard is part of the contract. Installation of new Scoreboard is not part of the contract.
19. Architectural Elevations illustrate the canopy as being supported by columns. This was drawn to provide suggested locations for columns, should they be needed by the PEMB. The canopy can be supported by whichever method the PEMB manufacturer chooses; column, hanger, direct connection etc..
20. Gutters along the plan east elevation of the building should extend to drains under the sidewalk and be daylighted beyond.
21. Contractor will be required to meet with Dave Easter City Inspector with the City of Mt. Carmel prior to start of construction.

PRODUCT/SUPPLIER APPROVALS

21. Approved ACI Buildings as a manufacturer for inclusion in Section 13 34 19 (Metal Building Systems), paragraph 2.1.
22. Approved Varco Pruden as a manufacturer for Section 13 34 19 (Metal Building Systems), paragraph 2.1
23. Approved Sport Turf Fast Grass AT740 as a manufacturer in Section 32 18 00 (Synthetic Grass Surfacing), paragraph 2.1.
24. Approved Old Castle Building Envelope as a manufacturer in Section 08 80 00 (Glazing), paragraph 2.1.

RFI RESPONSES

25. Is the G.C. responsible for any fees associated with the relocation of the utility pole.

G.C. will not be responsible for any costs associated with the relocation of the utility pole from the oil company. The line cannot remain out of service more than two calendar days. G.C. still responsible for all fees associated with required permitting for project, including any fees and work associated with the utility pole relocation. Coordinate with local utilities and owner a minimum of two weeks prior to commencement of work.
26. Is there a detail for the concrete slab to mount the HVAC units on? **Utilize a 6” thick slab, similar to the detail titled “REINFORCED 6” PCC PAVEMENT TYPICAL SECTION” on C-501.**
27. Would Illinois Eastern Community Colleges be open to hanger connections on the proposed canopy? **Yes. See clarification note 5.**
28. Clarify the note referring to a storm sewer: **There is no storm sewer within this project.**
29. Are you concerned about the overhead service lines being approximately 8’-0” from the building? Would you consider underground installation of the feeder lines? Would you

consider relocation of the pad mounted transformer closer to the relocated utility pole and service line?

These are multiple questions that were asked, but as they are about related work I am putting them all together.

Jobsite safety is the responsibility of the Contractor. We contacted steel erectors to get their input on the feasibility of the work being performed and they indicated that an 8'-0" gap to the feeder lines can be done. We would expect the sub-contractor performing the work to take all necessary steps to perform the work safely. This would include informing the public utility so that they can provide their support and whatever means they have to help ensure safety.

We would like to see the proposal bid as issued, but would be open to alternative methods to achieve the intended building design at no additional cost to the client.

30. Is there a staging area?

At this point in the project, we are anticipating being able to utilize a maximum 90' x 60' space in the gravel parking lot adjacent to the baseball and softball fields. However the parking lot will still need to be used so alternative locations would also be considered. We've provided as an attachment the schedule for the 2023-2024 seasons for Baseball, Softball, and Women's Soccer to provide an idea of how often that parking lot may be used. Security fencing will need to be erected, and any damage to the staging area will need to be repaired.

This addendum **DOES NOT** alter the previously published bid due date of **June 04, 2023, 02:00 pm, at Illinois Eastern Community Colleges District 529 Office, located at 233 East Chestnut Street, Olney, IL 62450.**

Respectfully submitted,

HURST-ROSCHE, INC.

Alexander Pape
Project Manager

cc: All known plan-holders (including plan houses and contractors), Hurst-Rosche web site, Illinois Eastern Community Colleges, Project File

RECEIVED BY:

Authorized Representative

Company Name

Date

HURST-ROSCHE, INC.

ATTENDANCE RECORD

Project No.: HR 395-3272
Project: Athletic Training Facility - Wabash Valley College

Meeting Description: Pre-Bid Meeting
Date: 05/15/2024: 10:00am - 12:00pm

Attendant

	Name	Representing	Phone	E-mail
1.	Jacob Rohrback	HCI	812-298-9110	jrohrback@hannigconstruction.com
2.	REGINA Blinn	WUI	812-886-1250	ginab@wabashutilities.com
3.	MIKE WOLF	WOLF CONST.	812-882-2260	wolfe@wolfeconstruction.co
4.	John Peters	H.E.Hodge	630-313-9367	jpeters@hehodge.com
5.	Tony Delgado	TLD Electric	618-263-7055	tdelgado.tld@gmail.com
6.	RICHARD JOHANNES	JOHANNES CONST.	618-533-3069	PRESTON@JOHANNESCONSTRUCTION.IL
7.	TOOD Retler	ARC CONST	812-426-0781	treller@construction.com
8.	Alex MEDONARD	KWOHTMAN	217-663-0076	alex@wohltmanconstruction.com
9.	Scott Collins	Altstadt	270-577-5928	Scott@altstadtplumb.com
10.	Kyle Nrebrugge	KWC	217-663-4570	kyle@wohltman-construction.com
11.		GBI	217-994-2997	
12.				
13.				
14.				
15.				
16.				
17.				
18.				
19.				
20.				

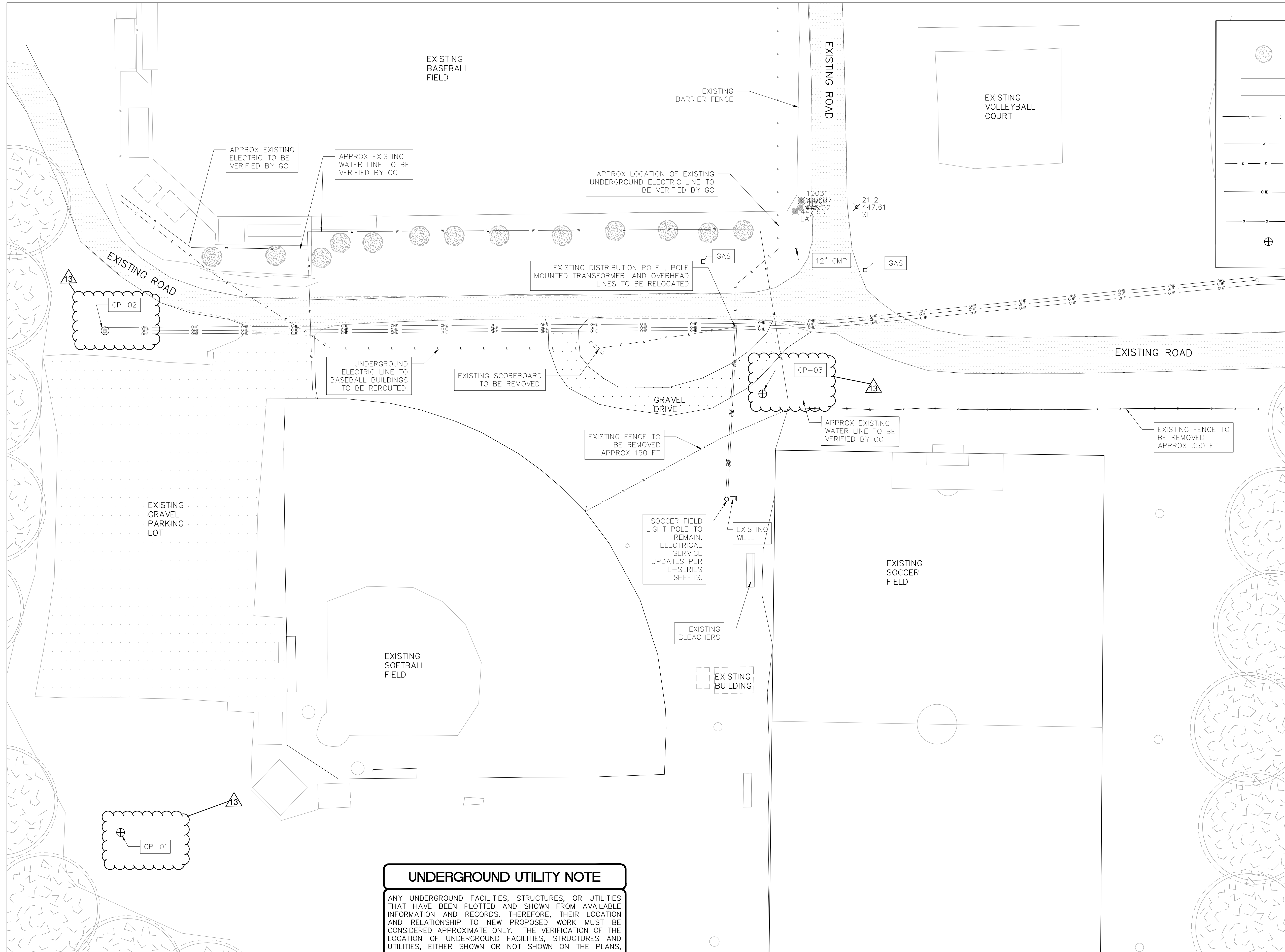

- EXISTING LANDSCAPE
- EXISTING ROAD
- EXISTING SAN SEWER
- EXISTING 12" WATER
- EXISTING ELECTRIC
- EXISTING OVERHEAD ELECTRIC
- EXISTING FENCE
- CONTROL POINT

UNDERGROUND UTILITY NOTE

ANY UNDERGROUND FACILITIES, STRUCTURES, OR UTILITIES THAT HAVE BEEN PLOTTED AND SHOWN FROM AVAILABLE INFORMATION AND RECORDS. THEREFORE, THEIR LOCATION AND RELATIONSHIP TO NEW PROPOSED WORK MUST BE CONSIDERED APPROXIMATE ONLY. THE VERIFICATION OF THE LOCATION OF UNDERGROUND FACILITIES, STRUCTURES AND UTILITIES, EITHER SHOWN OR NOT SHOWN ON THE PLANS, SHALL BE THE RESPONSIBILITY OF THE CONTRACTOR AND SHALL BE LOCATED PRIOR TO ANY WORK. IT IS THE CONTRACTOR'S RESPONSIBILITY TO NOTIFY ALL THE LOCAL GOVERNING AGENCIES AND UTILITY COMPANIES PRIOR TO CONSTRUCTION TO DETERMINE THEIR UNDERGROUND FACILITIES, STRUCTURES AND UTILITIES EXACT LOCATION AND THE EXISTENCE OF ANY NOT SHOWN. CONTRACTOR SHALL COORDINATE WITH UTILITY COMPANIES AND THE OWNER AS TO THE RELOCATION OR REMOVAL OF ANY UTILITIES SHOWN OR NOT SHOWN. THE ENGINEER/ARCHITECT AND THE OWNER DO NOT WARRANT OR GUARANTEE THE COMPLETENESS OR THE CORRECTNESS OF THE INFORMATION GIVEN.

CONTROL POINTS

POINT NO.	NORTHING	EASTING	ELEVATION	DESCRIPTION
CP-01	641025.411	1141929	440.588	IP CAP SET
CP-02	641336.507	1141919	443.296	IP CAP SET
CP-03	641297.426	1142327	445.607	IP CAP SET

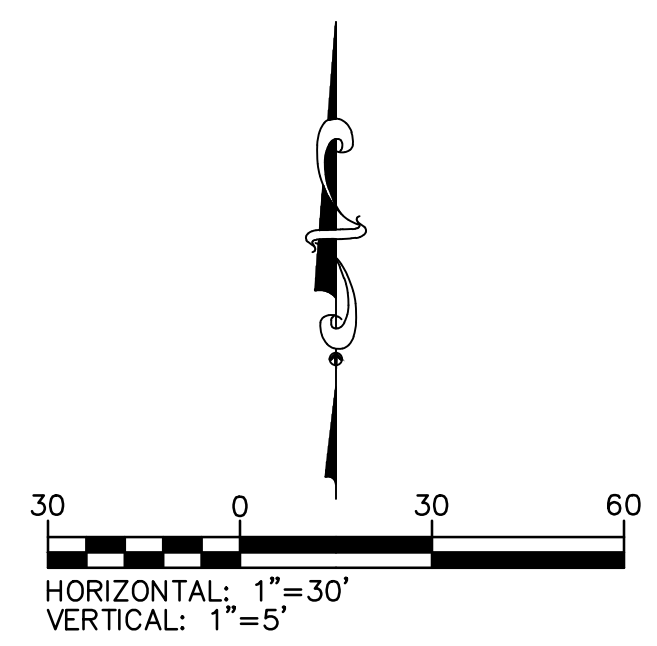

Hurst-Rosche, Inc.
 PROFESSIONAL DESIGN NUMBER: 184-02028
 200 NORTH MARKET ST. MARION, IL 62959
 PH: 618.998.0075
 HILLSBORO, IL
 EAST ST. LOUIS, IL
 ARNOLD, MO
 NASHVILLE, TN
 SPRINGFIELD, IL
 www.hurst-rosche.com

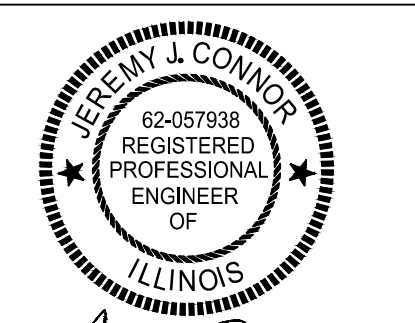

SIGNATURE
 05/22/2024
 DATE
 11-30-2025
 LICENSE EXPIRES

**ATHLETIC TRAINING FACILITY
 WABASH VALLEY COLLEGE
 2200 COLLEGE DRIVE, MOUNT CARMEL, IL. 62863
 ILLINOIS EASTERN COMMUNITY COLLEGES**

MK.	DATE	DESCRIPTION
13	05/22/24	ADDENDUM #02

DATE:
 PROJECT NO: 395-3272
 DESIGN: ZAY DRAWN: ZMS CHECK: JJC

DEMO

C 100

WABASH VALLEY COLLEGE BASEBALL SCHEDULE

2023-24 Wabash Valley Baseball Schedule

OVERALL 42-22	PCT. .656	CONF. 23-7	PCT. .767	STREAK Lost 2	HOME 19-8	AWAY 17-10	NEUTRAL 6-4
GAMES 64	RUNS 646	BATTING AVG. .343	ON BASE % .463	SLUGGING % .552	HOME RUNS 85		

All Events ▼

DATE	OPPONENT	NOTES	RESULT	STATUS	LINKS
JANUARY					
Sun. 28	vs. Dyersburg State Community College @ Millington, TN		W, 5-3	Final	Box Score
	vs. Dyersburg State Community College @ Millington, TN		W, 11-5	Final	Box Score
Wed. 31	at Spring Hill JV		W, 9-0	Final	Box Score
	at Spring Hill JV		W, 7-0	Final	Box Score

FEBRUARY					
Fri. 2	vs. Andrew College @ Panama City Beach, F		W, 11-2	Final - 7 innings	Box Score
Sat. 3	vs. Northwest Florida State College @ Panama City	Visit Panama City Beach Classic	L, 5-1	Final	Box Score
	vs. St. Johns River State College @ Panama City Beach, F		L, 5-1	Final - 7 innings	Box Score
Sun. 4	vs. Florence-Darlington Technical College @ Panama City Beach, F	Panama City Beach, FL	L, 12-10	Final - 7 innings	Box Score

DATE	OPPONENT	NOTES	RESULT	STATUS	LINKS
Fri. 9	vs. Danville Area Community College @ Millington, TN	2024 Saluqi Invitational	W, 9-2	Final	Box Score
Sat. 10	vs. Jefferson College @ USA Stadium	2024 Saluqi Invitational		Cancelled	
Tue. 13	at Oakland City University JV		W, 20-9	Final	Box Score
Sun. 18	vs. Galveston College @ San Jacinto College	Tournament of Champions	W, 5-1	Final	Box Score
	at San Jacinto College-North	Tournament of Champions	L, 17-10	Final	Box Score Video
Mon. 19	at Alvin Community College	Tournament of Champions	L, 8-3	Final - 7 innings	Box Score Video
	at Alvin Community College	Tournament of Champions	L, 12-9	Final	Box Score Video
Fri. 23	Chattahoochee Valley Community College		L, 8-4	Final - 7 innings	Box Score
	at Georgia Highlands College		L, 4-3	Final - 7 innings	Box Score
Sat. 24	at Georgia Highlands College		L, 8-2	Final - 7 innings	Box Score
	vs. Chattahoochee Valley Community College @ Cartersville, GA		W, 13-3	Final - 6 innings	Box Score

MARCH

Sat. 2	at Shelton State Community College		L, 5-4	Final	Box Score
	at Shelton State Community College		L, 9-6	Final	Box Score
Mon. 4	vs. Columbia State Community College @ Bowling Green, KY		L, 6-4	Final	Box Score
Thu. 7	Southwestern Illinois College *		W, 10-0	Final - 8 innings	Box Score
Sun. 10	at Southwestern Illinois College *		W, 7-6	Final	Box Score
	at Southwestern Illinois College *		W, 18-7	Final - 7 innings	Box Score
Wed. 13	at Lake Land College * ^		W, 19-10	Final	Box Score Video
Sat. 16	Lake Land College * ^		L, 17-13	Final	Recap Recap Box Score
	Lake Land College * ^		L, 11-7	Final	Recap Box Score
Tue. 19	at Heartland Community College		W, 23-11	Final	Box Score
Thu. 21	Shawnee Community College *		W, 8-2	Final	Box Score
Sat. 23	at Shawnee Community College *		W, 38-3	Final - 7 innings	Box Score

DATE	OPPONENT	NOTES	RESULT	STATUS	LINKS
	at Shawnee Community College *		W, 10-1	Final - 7 innings	Box Score
Tue. 26	Frontier Community College * ^		W, 10-0	Final - 7 innings	Box Score
Thu. 28	at Olney Central College *		W, 12-9	Final	Box Score
Fri. 29	Olney Central College *		W, 27-4	Final - 7 innings	Box Score
	Olney Central College *		W, 8-3	Final - 7 innings	Box Score

APRIL					
Fri. 5	Vincennes University		W, 2-0	Final	Recap Box Score
Sat. 6	Lake Area Post Grad Academy		W, 16-1	Final - 7 innings	Box Score
Tue. 9	at Frontier Community College * ^		L, 9-6	Final	Box Score
	at Frontier Community College * ^		W, 10-5	Final - 7 innings	Box Score
Sat. 13	at Rend Lake College * ^		W, 4-1	Final	Box Score
	at Rend Lake College * ^		W, 13-1	Final - 7 innings	Box Score
Sun. 14	Rend Lake College * ^		W, 7-6	Final	Box Score
Tue. 16	at Lincoln Trail College *		W, 19-6	Final - 7 innings	Box Score Photos
Thu. 18	at Kaskaskia College * ^		W, 7-0	Final	Box Score
Sat. 20	Kaskaskia College * ^		W, 6-5	Final - 10 innings	Box Score
	Kaskaskia College * ^		L, 6-5	Final - 8 innings	Box Score
Tue. 23	Lincoln Trail College *		W, 19-7	Final - 7 innings	Box Score
	Lincoln Trail College *		L, 12-11	Final - 7 innings	Box Score
Thu. 25	at Southeastern Illinois College * ^		W, 18-1	Final - 7 innings	Box Score
Sat. 27	Southeastern Illinois College * ^		W, 12-0	Final - 7 innings	Box Score
	Southeastern Illinois College * ^		W, 9-0	Final - 7 innings	Box Score
Mon. 29	at St. Charles Community College		W, 12-5	Final	Box Score

MAY					
Thu. 2	John A. Logan College * ^		W, 13-3	Final - 8 innings	Recap Box Score
Fri. 3	at John A. Logan College * ^		L, 7-6	Final	Box Score
	at John A. Logan College * ^		L, 9-3	Final - 7 innings	Box Score
Thu. 9	Lincoln Trail College	Region 24 Tournament	L, 13-6	Final	Recap Box Score

DATE	OPPONENT	NOTES	RESULT	STATUS	LINKS
Fri. 10	Kaskaskia College %		W, 9-4	Final	Box Score
	Frontier Community College %		W, 7-0	Final	Box Score
Sat. 11	Lincoln Trail College %	Region 24 Championship	W, 15-4	Final	Box Score
	Lincoln Trail College %	Region 24 Championship	W, 20-4	Final	Recap Box Score
Wed. 15	Iowa Western Community College %		W, 11-1	Final - 6 innings	Box Score
Thu. 16	John A. Logan College %	Midwest District Tournament	W, 11-3	Final - 7 innings	Box Score
Fri. 17	Iowa Western Community College %	Midwest District Tournament	L, 16-5	Final	Box Score
Sat. 18	Iowa Western Community College %	Midwest District Tournament	L, 7-5	Final - 10 innings	Box Score

* Conference ^ Division % Post season **Bold team:** Home event

 [iCalendar](#)  [RSS Feed](#)

Share    



***If You've Got The Game
We've Got The Gear***

- All Americans
- Past Seasons
- Records

WABASH VALLEY COLLEGE WOMEN'S SOCCER SCHEDULE

2023-24 Warriors Women's Soccer Schedule

OVERALL 6-9-2	PCT. .412	CONF. 1-0	PCT. 1.000	STREAK Lost 1	HOME 4-3-1	AWAY 1-5-1	NEUTRAL 1-1
GAMES 17	GOALS 29	GOALS/ GAME 1.71	SHOT % .592	SHOTS/ GAME 2.9	GAA 2.31		

All Events 

DATE	OPPONENT	NOTES	RESULT	STATUS	LINKS
AUGUST					
Sat. 19	at Brescia University #	Scrimmage		12:00 PM	
Mon. 21	at Greenville University #	Scrimmage		7:00 PM	
Wed. 23	Rose Hulman Institute of Technology #	Scrimmage		Cancelled	
Sat. 26	East Central College		W, 5-1	Final	Recap Box Score
Mon. 28	at Southwest Tennessee Community College		T, 1-1	Final	Recap Box Score

SEPTEMBER					
Fri. 1	Columbia State Community College		L, 4-0	Final	Box Score
Tue. 5	at Indian Hills Community College	Ottumwa, IA	L, 1-0	Final	Recap Box Score Photos Video
Sat. 9	Illinois Central College		W, 2-0	Final	Box Score
Wed. 13	at Lewis & Clark Community College		L, 2-1	Final	Box Score
Sun. 17	vs. Spartanburg Methodist @ Motlow State		W, 1-0	Final	Box Score
Mon. 18	at Motlow State Community College	Moore County Campus	L, 2-1	Final	Recap Box Score
Wed. 20	at Lincoln Trail College *		W, 4-1	Final	Box Score
Sat. 23	at Illinois Central College	East Peoria, IL	L, 4-0	Final	Box Score
Wed. 27	Lewis & Clark Community College		L, 6-0	Final	Box Score

DATE	OPPONENT	NOTES	RESULT	STATUS	LINKS
Sat. 30	Lincoln Land Community College		W, 7-0	Final	Box Score

OCTOBER

Wed. 4	Southwestern Illinois College		L, 3-0	Final	Box Score
Sat. 7	at Heartland Community College		L, 6-1	Final	Box Score
Wed. 11	Lincoln Trail College		W, 3-1	Final	Box Score
Sun. 15	Southwest Tennessee Community College		T, 1-1	Final	Box Score
Fri. 20	vs. Indian Hills Community College % @ Godfrey, IL		L, 4-2	Final	Box Score Video

FEBRUARY

Tue. 27	at UK Soccer Club	Scrimmage		5:00 PM	
---------	-------------------	-----------	--	---------	--

MARCH

Thu. 21	at Kentucky Wesleyan JV	Scrimmage		TBA	
---------	-------------------------	-----------	--	-----	--

APRIL

Sat. 6	at Georgetown College	Scrimmage		TBA	
Sat. 13	at Greenville University	Scrimmage		TBA	

Exhibition * Conference % Post season **Bold team:** Home event

 [iCalendar](#)  [RSS Feed](#)

Share



- Past Seasons
- Records

WABASH VALLEY COLLEGE SOFTBALL SCHEDULE

2023-24 Wabash Valley Softball Schedule

OVERALL 30-28	PCT. .517	CONF. 21-15	PCT. .583	STREAK Lost 2	HOME 15-8	AWAY 13-17	NEUTRAL 2-3
GAMES 58	RUNS 265	BATTING AVG. .307	ON BASE % .359	SLUGGING % .436	HOME RUNS 34		

All Events ▼

DATE	OPONENT	NOTES	RESULT	STATUS	LINKS
SEPTEMBER					
Sun. 10	at Lincoln Trail College #			11:00 AM	
	vs. Olney Central College #	IECC Showcase		1:00 PM	
Sat. 16	at Indiana State University #			2:15 PM	
	vs. Saint Mary-of-the-Woods College #			4:30 PM	
Tue. 19	at University of Southern Indiana #			3:00 PM	
	at University of Southern Indiana #			5:00 PM	
Sun. 24	at University of Illinois #			TBA	
Sat. 30	at Southern Illinois Univeristy Edwardsville #			3:00 PM	

OCTOBER					
Sun. 1	Indiana University-Purdue University Columbus #			TBA	
Sun. 8	at Eastern Illinois University #			1:00 PM	
Fri. 13	at Oakland City University #			2:00 PM	
	at Oakland City University #			4:00 PM	
Sat. 21	at Kentucky Wesleyan College #			1:00 PM	
	at Kentucky Wesleyan College #			3:00 PM	
Sun. 22	Oakland City University #			12:00 PM	
	Oakland City University #			2:00 PM	

DATE	OPPONENT	NOTES	RESULT	STATUS	LINKS
FEBRUARY					
Thu. 8	at Northeast Mississippi Community College		W, 4-2	Final	Box Score
	at Northeast Mississippi Community College		L, 9-1	Final - 5 innings	Box Score Video
Fri. 9	vs. Itawamba Community College		W, 7-3	Final	Box Score Video
	vs. Itawamba Community College		L, 10-4	Final	Box Score Video
Fri. 16	at Roane State Community College		L, 2-1	Final	Box Score
	at Roane State Community College		W, 6-4	Final	Box Score
Sat. 17	at Volunteer State Community College		L, 9-1	Final - 5 innings	Box Score
	at Volunteer State Community College		L, 18-3	Final - 5 innings	Box Score
Sat. 24	vs. Marion Military Institute		L, 8-6	Final	Box Score
	vs. Wallace State Community College-Hanceville		W, 6-5	Final	Box Score
Sun. 25	vs. Volunteer State Community College	JUCO Extravaganza	L, 5-2	Final	Box Score
	at Snead State Community College	Field 3	L, 9-8	Final	Box Score
Thu. 29	Rend Lake College * ^		W, 10-1	Final - 5 innings	Box Score
	Rend Lake College * ^		L, 10-4	Final	Box Score

MARCH					
Sat. 2	at Southwestern Illinois College * ^		W, 2-1	Final	Box Score
	at Southwestern Illinois College * ^		W, 5-2	Final	Box Score
Thu. 7	Lake Land College * ^		L, 5-0	Final	Recap Box Score
	Lake Land College * ^		L, 6-0	Final	Box Score
Sun. 10	at Southeastern Illinois College *		W, 11-5	Final	Box Score
	at Southeastern Illinois College * ^		W, 8-4	Final	Box Score
Thu. 14	Shawnee Community College * ^		W, 12-0	Final - 5 innings	Box Score
	Shawnee Community College * ^		W, 6-2	Final	Box Score
Sat. 16	Olney Central College * ^		W, 10-4	Final	Box Score

DATE	OPPONENT	NOTES	RESULT	STATUS	LINKS
	Olney Central College * ^		W, 6-0	Final	Box Score
Thu. 21	Frontier Community College ^		W, 4-2	Final	Box Score
	Frontier Community College ^		W, 7-6	Final	Box Score
Sat. 23	at John A. Logan College * ^		L, 5-1	Final	Box Score
	at John A. Logan College * ^		L, 9-2	Final	Box Score
Thu. 28	at Lincoln Trail College * ^		L, 3-0	Final	Box Score
	at Lincoln Trail College * ^		L, 7-6	Final - 8 innings	Box Score

APRIL

Thu. 4	at Rend Lake College * ^		W, 14-2	Final - 5 innings	Box Score
	at Rend Lake College * ^		L, 5-4	Final	Box Score
Sat. 6	Southwestern Illinois College * ^		W, 2-1	Final - 11 innings	Box Score
	Southwestern Illinois College * ^		W, 3-1	Final	Box Score
Tue. 9	at Lake Land College * ^		L, 5-4	Final - 10 innings	Box Score
	at Lake Land College * ^		L, 5-0	Final	Box Score
Sat. 13	at Shawnee Community College * ^		W, 5-3	Final	Box Score
	at Shawnee Community College * ^		W, 10-1	Final - 5 innings	Box Score
Sun. 14	Southeastern Illinois College * ^		W, 2-0	Final	Box Score
	Southeastern Illinois College * ^		L, 4-3	Final	Box Score
Tue. 16	at Kaskaskia College * ^		W, 8-3	Final	Box Score
	at Kaskaskia College * ^		L, 3-1	Final	Box Score
Thu. 18	at Olney Central College * ^		W, 13-3	Final	Box Score
	at Olney Central College * ^		W, 8-0	Final - 5 innings	Box Score
Sat. 20	at Frontier Community College ^		L, 12-8	Final	Box Score
	at Frontier Community College ^		L, 11-3	Final - 5 innings	Box Score
Tue. 23	John A. Logan College * ^		W, 4-1	Final	Box Score
	John A. Logan College * ^		L, 6-1	Final	Box Score
Sat. 27	Lincoln Trail College * ^		L, 13-5	Final - 6 innings	Box Score
	Lincoln Trail College * ^		W, 6-3	Final	Box Score
Tue. 30	Kaskaskia College * ^		W, 10-0	Final - 5 innings	Box Score

DATE	OPPONENT	NOTES	RESULT	STATUS	LINKS
	Kaskaskia College * ^		L, 2-1	Final	Box Score
MAY					
Sat. 4	Southeastern Illinois College %		L, 2-0	Final	Box Score
	Southeastern Illinois College %		W, 9-1	Final - 5 innings	Box Score
Sun. 5	Southeastern Illinois College %		W, 2-0	Final	Box Score
Sat. 11	at John A. Logan College %	Region XXIV Final Four	W, 8-2	Final	Box Score
	at Lake Land College	Region XXIV Tournament	L, 9-3	Final	Box Score
Sun. 12	at John A. Logan College %		L, 12-3	Final - 6 innings	Box Score

Exhibition * Conference ^ Division % Post season **Bold team:** Home event

 [iCalendar](#)  [RSS Feed](#)

Share    



***If You've Got The Game
We've Got The Gear***